

DIMENSIONS & ELECTRICAL CHARACTERISTICS

Bussmann®

NH DIN Dual Indication Fuse Links

Class of Operation gL/gG, 500V AC, 10 to 630 Amps
 Sizes 000 to 3

NH



Standards/
 Approvals:

IEC 60269, VDE0636,
 DIN 43 620 Part 1 to 4.

Description:

A square bodied range of industrial fuse links for a wide variety of applications.

Packaging:

All fuse links are packed in 3's.

Technical Data:

Rated Voltage: 500V AC
 Rated Breaking Capacity: 120kA
 Rated Frequency: 50Hz
 Operating Frequency: 45-62 Hz
 Design -Insulator: Steatite
 -Metal Parts: Corrosion-proof (aluminium)

Contact Blade:

Full contact blades,
 Silver plated copper

CATALOGUE SYMBOL: (amp)NHG(Size)B
 HRC FUSE LINKS
 CLASS OF OPERATION gL/gG
 500V AC
 10 to 630 AMPS
 SIZES 000 to 3

Dimensional Data

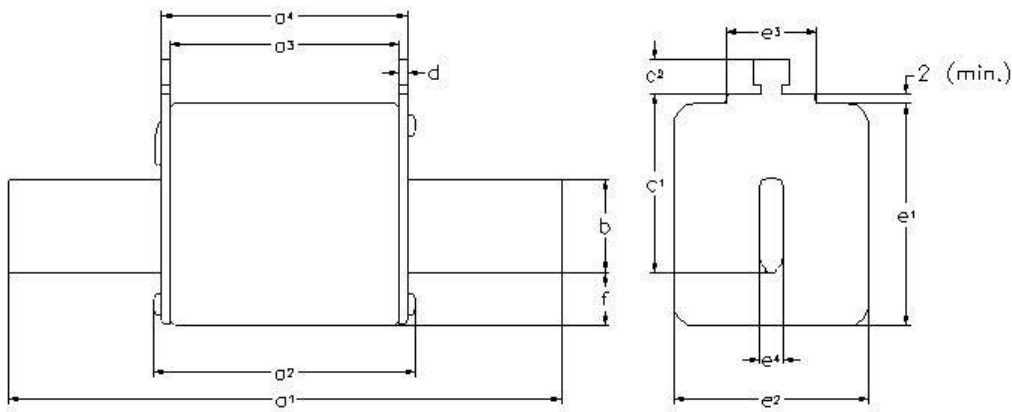

Size a	a1	a2 (max)	a3	a4	b (nom)	c1(± 8)	c2 (nom)	D (nom)	e1 (max)	e2 (max)	e3 (max)	e4 (nom)	f (max)
000	78.5 ± 1.5	54	45 ± 1.5	49 ± 1.5	15	35	10	2 ± 0.5	41	21	21	6	8
00	78.5 ± 1.5	54	45 ± 1.5	49 ± 1.5	15	35	10	2.5 ± 0.5	48	30	25	6	15
0	125 ± 2.5	68	62 ± ⁺³ / _{-1.5}	68 ± ^{-1.5} / ₃	15	35	11	2.5 ± 0.5	48	30	25	6	15
01	135 ± 2.5	75	62 ± 2.5	68 ± 2.5	15	40	11	2.5 ± 0.5	48	30	25	6	15
1	135 ± 2.5	75	62 ± 2.5	68 ± 2.5	20	40	11	2.5 ± 0.5	53	52	25	6	15
02	150 ± 2.5	75	62 ± 2.5	68 ± 2.5	20	48	11	2.5 ± 0.5	53	52	25	6	15
2	150 ± 2.5	75	62 ± 2.5	68 ± 2.5	25	48	11	2.5 ± 0.5	61	60	25	6	15
03	150 ± 3	75	62 ± 2.5	68 ± 2.5	25	60	11	2.5 ± 0.5	61	60	25	6	15
3	150 ± 3	75	62 ± 2.5	68 ± 2.5	32	60	11	3 ± 0.5	76	75	25	6	18

NH DIN Dual Indication Fuse Links

Class of Operation gL/gG, 500V AC, 10 to 100 Amps
 Sizes 000

NH

Time Current Characteristics for Size 000

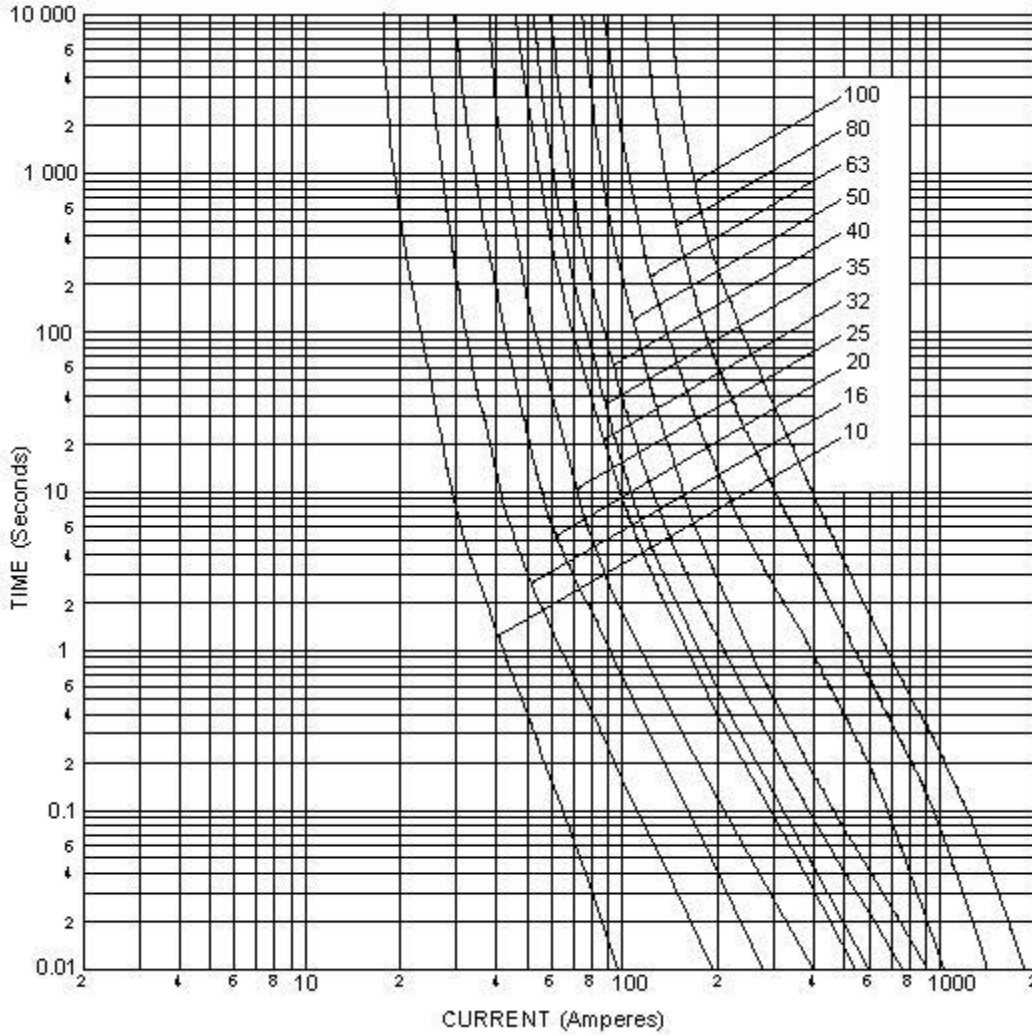

Size 000 Details:
Standards/Approvals: IEC60269, DIN 43 620, VDE0636
Rated Currents: 10, 16, 20, 25, 32, 35, 40, 50, 63, 80 & 100 Amps

Part Number	Amp Rating	Watts Loss	Net weight per fuse	Rated Voltage
10NHG000B	10	1.5	0.119 kg	500Vac
16NHG000B	16	2.3		
20NHG000B	20	2.2		
25NHG000B	25	2.8		
32NHG000B	32	3.7		
35NHG000B	35	3.7		
40NHG000B	40	4.0		
50NHG000B	50	4.9		
63NHG000B	63	4.5		
80NHG000B	80	6.3		
100NHG000B	100	7.4		

NH DIN Dual Indication Fuse Links
 Class of Operation gL/gG, 500V AC, 125 & 160 Amps
 Sizes 00

NH

Time Current Characteristics for Size 00

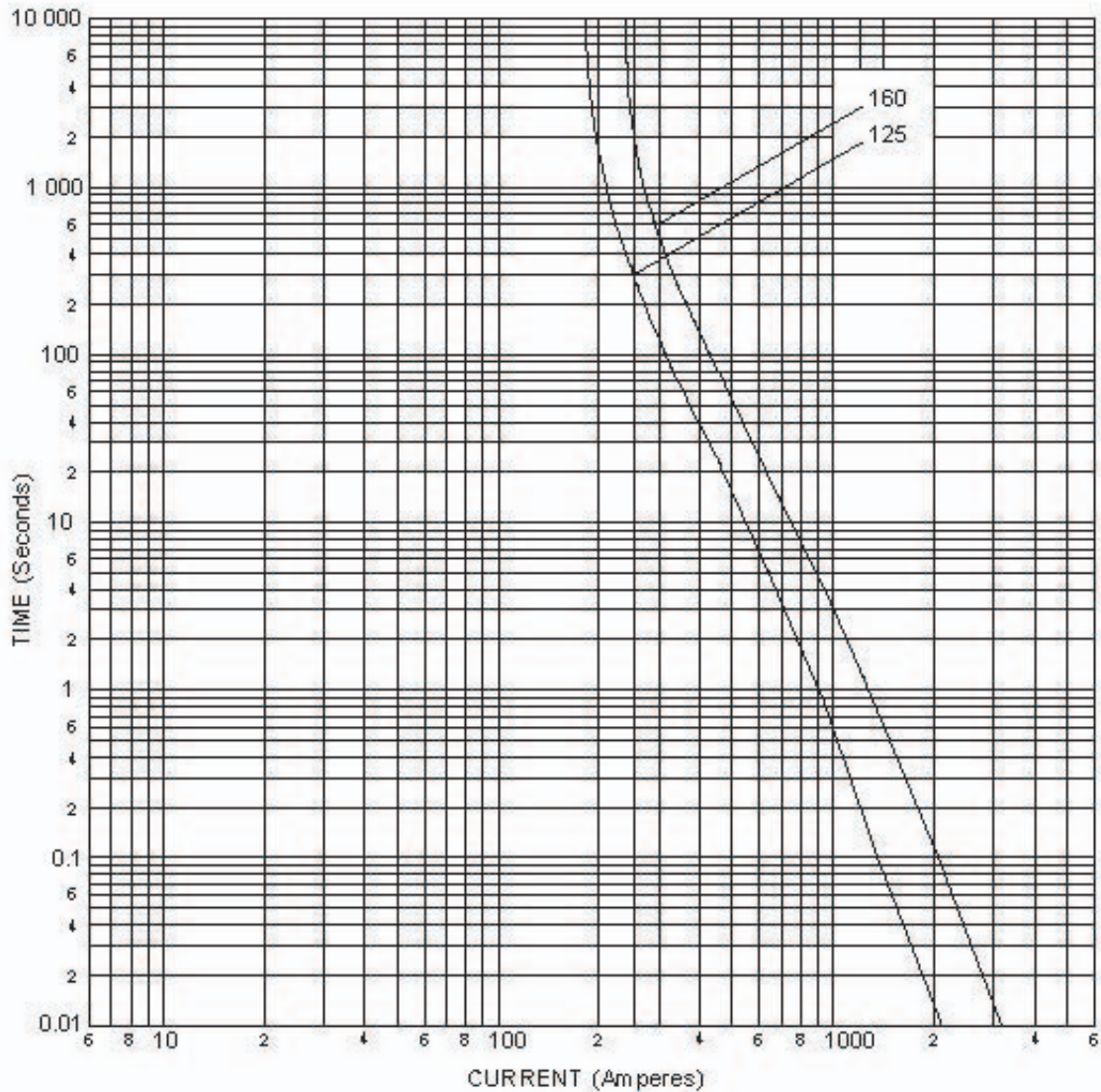

Size 00 Details:
Standards/Approvals: IEC60269, DIN 43 620, VDE0636
Rated Currents: 125 & 160 Amps

Part Number	Amp Rating	Watts Loss	Net weight per fuse	Rated Voltage
125NHG00B	125	10.0	0.185 kg	500Vac
160NHG00B	160	10.0		

NH DIN Dual Indication Fuse Links

Class of Operation gL/gG, 500V AC, 10 to 160 Amps
 Sizes 0

NH

Time Current Characteristics for Size 0

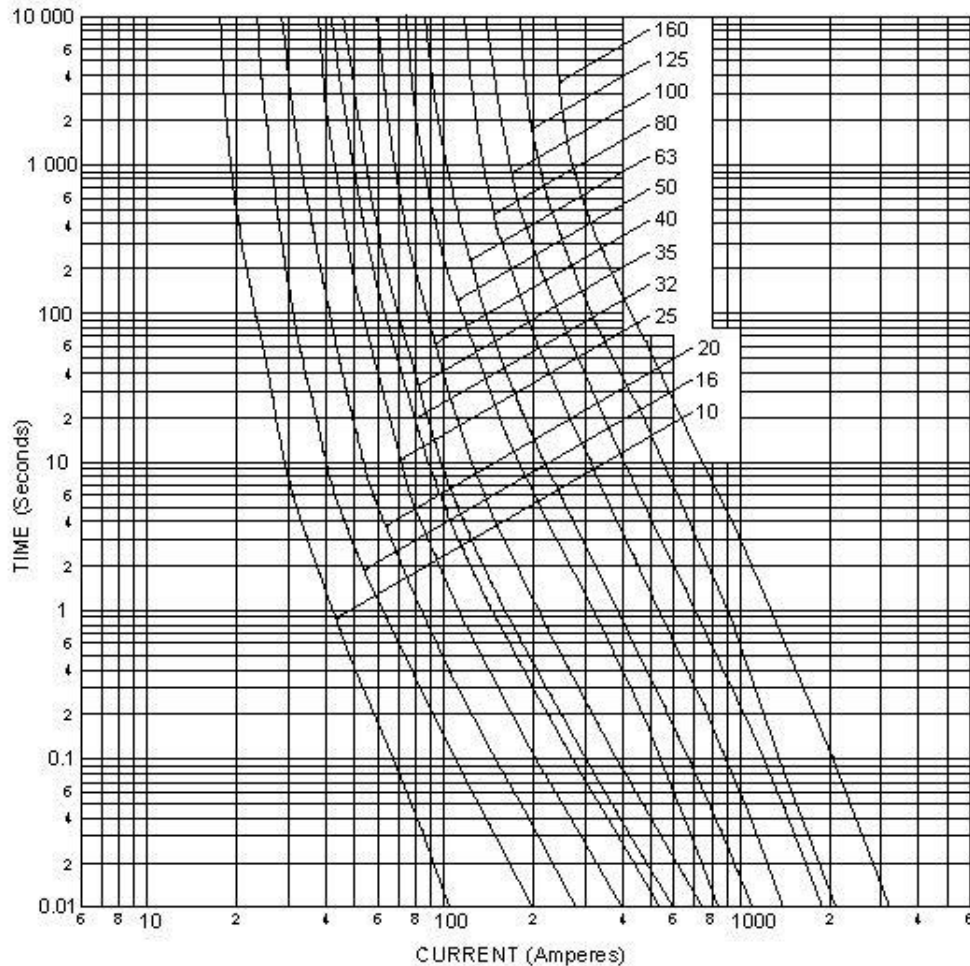

Size 0 Details:
Standards/Approvals: IEC60269, DIN 43 620, VDE0636
Rated Currents: 10, 16, 20, 25, 32, 35, 40, 50, 63, 80, 100, 125 & 160 Amps

Part Number	Amp Rating	Watts Loss	Net weight per fuse	Rated Voltage
10NHG0B	10	1.7	0.251kg	500Vac
16NHG0B	16	3.0		
20NHG0B	20	3.2		
25NHG0B	25	3.2		
32NHG0B	32	4.8		
35NHG0B	35	4.4		
40NHG0B	40	4.7		
50NHG0B	50	6.3		
63NHG0B	63	5.6		
80NHG0B	80	7.1		
100NHG0B	100	7.5		
125NHG0B	125	10.0		
160NHG0B	160	11.5		

NH DIN Dual Indication Fuse Links

Class of Operation gL/gG, 500V AC, 10 to 250 Amps
 Sizes 01 & 1

NH

Time Current Characteristics for Size 01 & 1

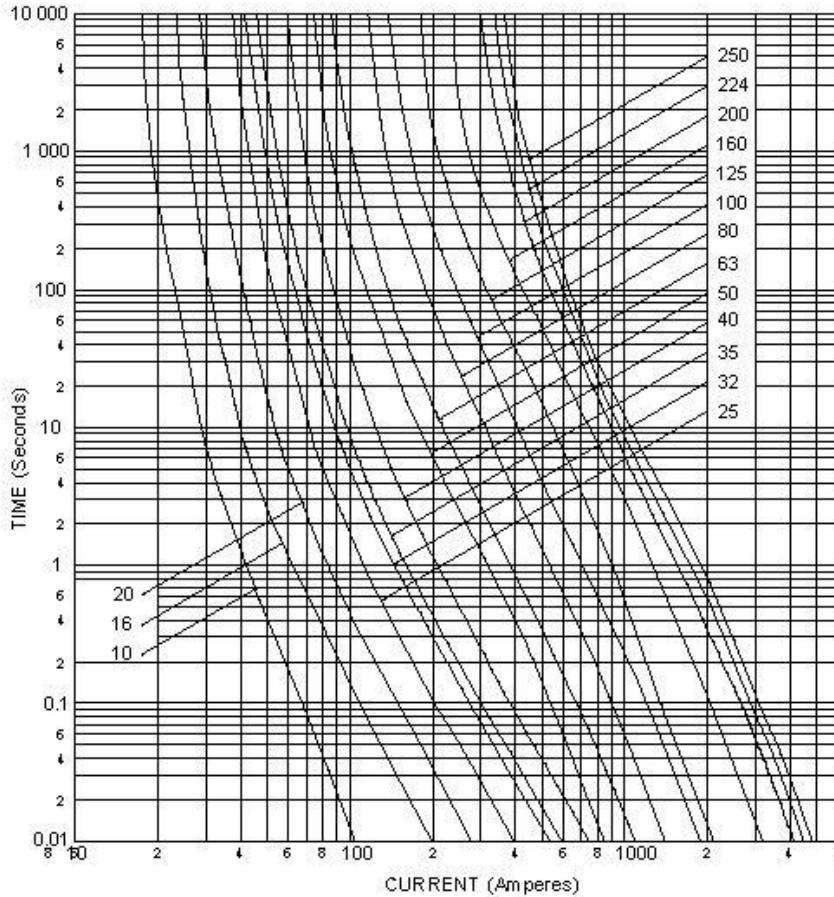

Size 01 & 1 Details:
Standards/Approvals: IEC60269, DIN 43 620, VDE0636
Rated Currents: 10, 16, 20, 25, 32, 35, 40, 50, 63, 80, 100, 125, 160, 200, 224 & 250 Amps

Part Number	Amp Rating	Watts Loss	Net weight per fuse	Rated Voltage
10NHG01B	10	2.0	0.269kg	500Vac
16NHG01B	16	3.0		
20NHG01B	20	3.2		
25NHG01B	25	3.2		
32NHG01B	32	4.8		
35NHG01B	35	4.6		
40NHG01B	40	5.0		
50NHG01B	50	6.7		
63NHG01B	63	5.6		
80NHG01B	80	7.1		
100NHG01B	100	7.7		
125NHG01B	125	11.6		
160NHG01B	160	12.3		
200NHG1B	200	15.0	0.387kg	
224NHG1B	224	15.0		
250NHG1B	250	19.0		

NH DIN Dual Indication Fuse Links

Class of Operation gL/gG, 500V AC, 35 to 400 Amps
 Sizes 02 & 2

NH

Time Current Characteristics for Size 02 & 2

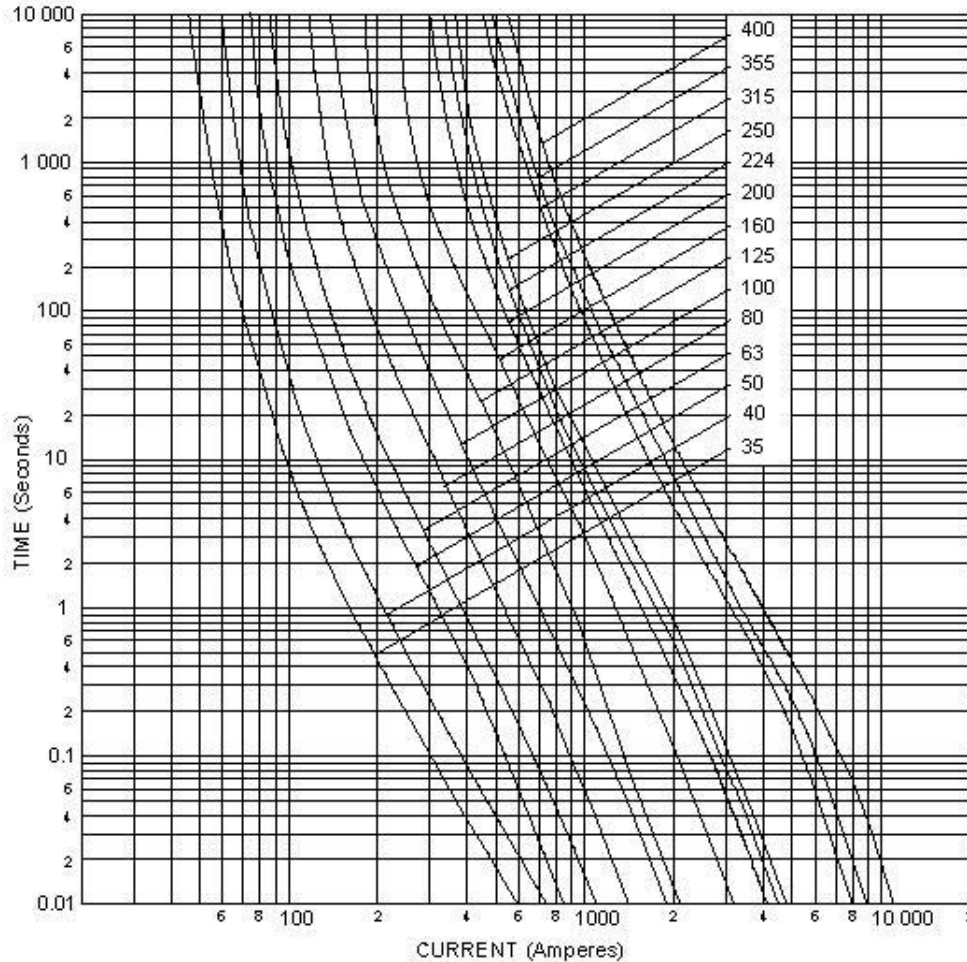

Size 02 & 2 Details:
 Standards/Approvals:
 Rated Currents:

IEC60269, DIN 43 620, VDE0636
 35, 40, 50, 63, 80, 100, 125, 160, 200,
 224, 250, 315, 355 & 400 Amps

Part Number	Amp Rating	Watts Loss	Net weight per fuse	Rated Voltage
35NHG02B	35	4.4	0.402kg	500Vac
40NHG02B	40	5.0		
50NHG02B	50	6.4		
63NHG02B	63	6.0		
80NHG02B	80	7.0		
100NHG02B	100	8.0		
125NHG02B	125	12.0		
160NHG02B	160	12.0		
200NHG02B	200	15.0		
224NHG02B	224	15.0		
250NHG02B	250	19.0	0.630kg	500Vac
315NHG2B	315	21.0		
355NHG2B	355	27.0		
400NHG2B	400	29.0		

NH DIN Dual Indication Fuse Links

Class of Operation gL/gG, 500V AC, 250 to 630 Amps
 Sizes 03 & 3

NH

Time Current Characteristics for Size 03 & 3

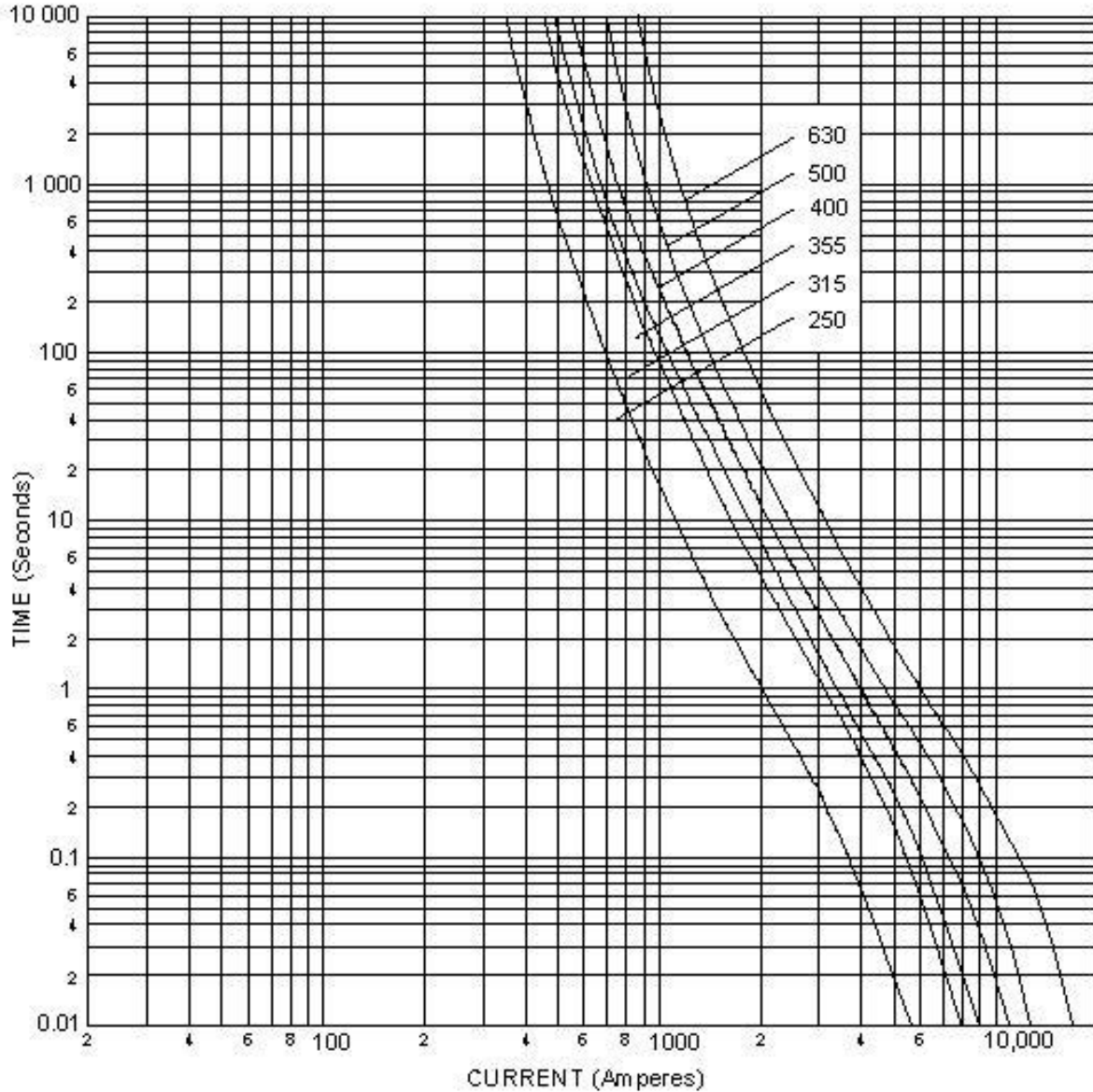

Size 03 & 3 Details:
Standards/Approvals:
Rated Currents:

IEC60269, DIN 43 620, VDE0636
250, 315, 355, 400, 500 and 630 Amps

Part Number	Amp Rating	Watts Loss	Net weight per fuse	Rated Voltage
250NHG03B	250	20.0	0.634kg	500Vac
315NHG03B	315	21.0		
355NHG03B	355	27.0		
400NHG03B	400	29.0		
500NHG3B	500	37.0	1.043kg	
630NHG3B	630	46.0		

NH DIN Dual Indication Fuse Links

Class of Operation gL/gG, 500V AC, 10 to 630 Amps

NH

Cut off Current Characteristics

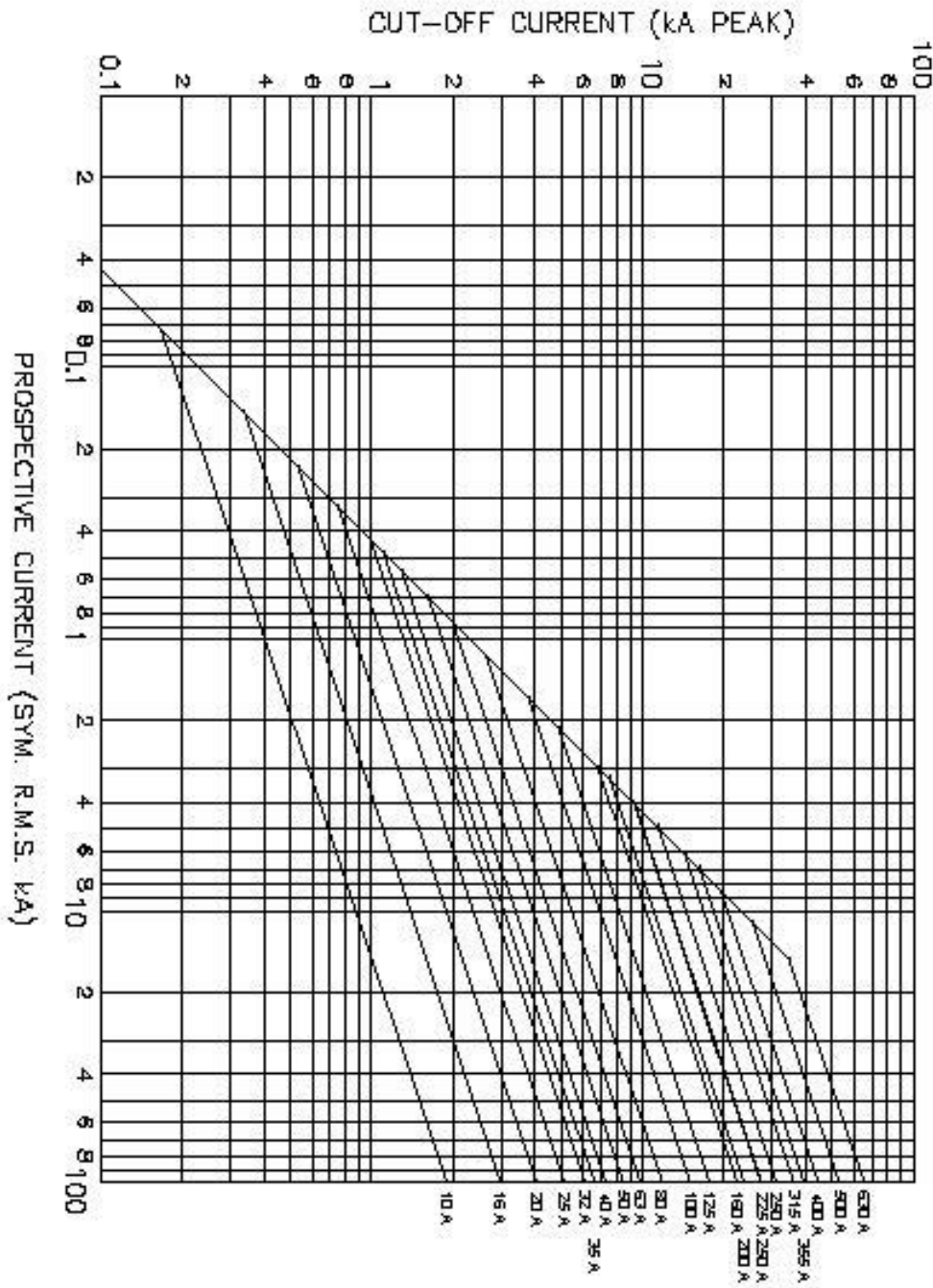

Size 000 to 3 Details:
Standards/Approvals:
Rated Currents:

IEC60269, DIN 43 620, VDE0636 Part 1
10 to 630 amps